



The economic solution for domestic wastewater disposal

Aqualift F Basic lifting station



Brand-name proven quality - competitive pricing

The *Aqualift F Basic* lifting station is the latest model in our quality lifting station series. It has been developed to satisfy all of the requirements of modern sewage technology, though at the same time takes into account profitability and efficiency for the user.

Our result is a lifting station that can handle any job in private households with its powerful pump. Designed for handling wastewater from drainage fixtures such as toilets, showers or sinks. The flexible connection options on three different sides of the tank means that it can be installed easily with minimum space requirements. The included control unit ensures continuous monitoring and a safe control of the lifting station.

The Aqualift F Basic is the new standard and **economic solution** for wastewater disposal.
Made in Germany! Made by KESSEL!

SPACE-SAVING, POWERFUL, RELIABLE

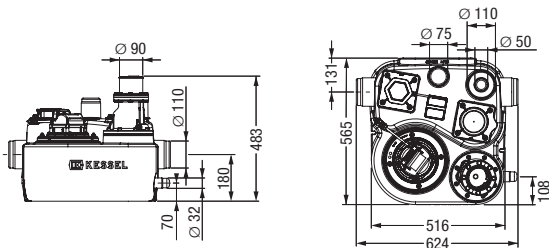

Pump type	SPF 1300
Flow rate	28 m ³ /h
Lifting height	8,5 m
Power (P2)	1,0 kW
Input power (P1)	1,5 kW
Voltage	230 V
Frequency	50 Hz
Amperage	6,7 A
Fuse protection	C 10 A
Protection (Pump)	IP68 3 m / 48 h
Protection (Control unit)	IP 54
Operating mode	S3 – 15 %
Weight	approx. 24 kg
Cable length	5 m

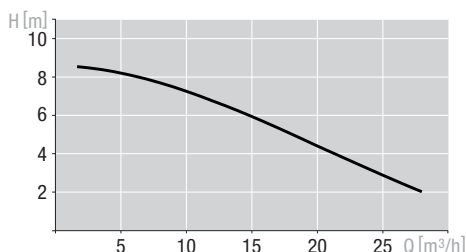

FLEXIBLE

Three prefabricated inlet connections (vertical and horizontal) ensure flexibility when connecting the drain pipes. An additional area in the back allows further connections up to $\varnothing 110$ mm at any position.

CLEAN

The interior sloped base of the tank guides solids directly to the pump, thus ensuring a full and clean extraction of all wastewater.

EXACT

Large float switch with high buoyancy and 3 positions (ON/OFF/ALARM) for fail-safe and precise pump control.

***Aqualift F Basic* lifting station for wastewater with and without sewage for free-standing installation in frost-free rooms**

Mono-station with one SPF 1300, float switch controlled pump with non-chokable impeller. Polyethylene storage tank with screwed access opening. Tank volume approx. 50 litres, maximum pumping volume approx. 20 litres.

Open channel passage 40 mm. Pump is rated submersible. Including backwater preventer, with plastic spigot pressure outlet DN 80 (Ø 90 mm).

Inlet connection from above Ø 50/110 mm. Two additional Ø 110 mm inlet connections at both sides. Spigot end of the pressure pipe DN 80 is fitted, including elastic hose connection. Flange adapter to a standard flange DN 80 is optional. With Ø 75 mm vent connection. Connection for Ø 32 mm manual emergency pump.

Tank includes fastening option for buoyancy control. Fastening material not included in the scope of delivery. Including float control for switch and alarm level detection. Including KESSEL control unit *Aqualift Basic* 230 V. With function display, button for manual pump start and to reset alarm. Battery buffered alarms (battery included). With connection option for on-site potential free-contact. Sewage lifting station in accordance with EN 12050-1.

Article number 28 798

Alarm reset button

Manual pump start button



Connection option for on-site potential-free contact



VENT DEVICE

To drain pressure line prior to maintenance work.



ADJUSTABLE

The position of the float switch can be adapted to the inlet. This means that its function is not affected by incoming wastewater flow.



RELIABLE

Powerful, tough pump that is safe to run dry with non-chokable impeller ensures a reliable operation of the station.

CE EN 12050-1

ACCESSORIES *Aqualift F Basic*

Closure valve in PE

vertical, DN 90, for the pressure pipe of KESSEL lifting stations with plastic fitting, in combination with in scope of delivery included spigot end

Article Number : **28 715**

Closure valve with flange adaptor in PE

vertical, DN 90, for the pressure pipe of KESSEL lifting stations with plastic fitting, with screwed flange adaptor, for connection to a standard flange DN 80 according to DIN 2501

Article Number : **28 716**

Connection flange in PE

for KESSEL plastic fittings, \varnothing 110 mm, spigot end for DN 100 pressure pipe connection. Also in combination with closure valve article number 28715

Article Number : **28 712**

Flexible pressure pipe connection

Re-enforced connection coupling (L = 200 mm) with twin brackets DN 100.

Article Number : **28 663**

Sound absorption mat

10 mm thick

Article Number : **28 692**

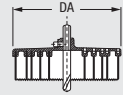
Hole saw \varnothing 50, 75, 110, 125 and 160 mm

(saw blade holder \varnothing = 190 mm)

Article Number : **50 100**



Pipe sealing gasket

Pipe size DN	Pipe outer diameter in mm	Cut hole size in mm	Article Number
50	50	60	850114
70	75	90	850116
100	110	118	850117

KESSEL AG

Bahnhofstraße 31 · 85101 Lenting, Germany

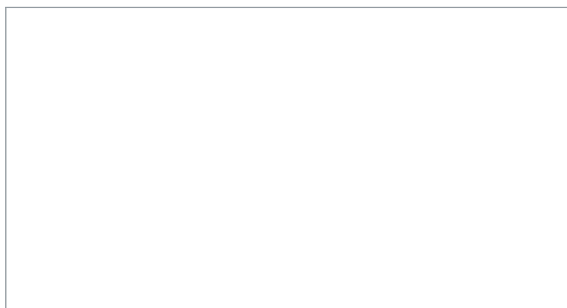
www.kessel.com



Rights reserved for technical changes