

## Clean out *Controlfix*

### The practical upgrade solution.

The foundation stone for your safety: Clean outs are installed at regular intervals in the drainage pipes in order to be able to clear out any blockages more easily. Our clean out *Controlfix* also facilitates this task further with its practical quick-release closures, enabling you to carry out maintenance quickly and without the need for tools.

Would you like to retain the option to retrospectively equip your drainage pipe with a backwater valve? The *Controlfix* clean out is ideally suited for this too – as it can be easily upgraded in situ to a *Staufix* backwater valve or a *Pumpfix F* backwater pumping station!

### Clean out *Controlfix*

Installation in a concrete slab / floor

Made of polymer, with telescopic upper section for continuous height- and level adjustment. For installation depth (D) from 486 – 640 mm, Installation area 750 × 750 mm. With surface water tight cover plate class A 15 made of polymer.

Installation kit with choice of cover.

#### ➤ Accessories:

- Extension sections for installation in waterproof concrete see page 52
- Conversion kits see page 35

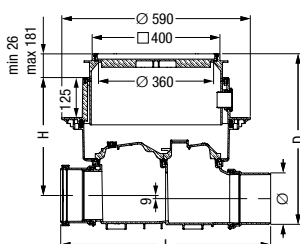

Outer diameter Ø (mm)	L × H in mm	Art. no.
With recessed cover for on-site tiling		
Ø 110	642 × 394	<b>80 100X</b>
Ø 125	645 × 387	<b>80 125X</b>
Ø 160	656 × 370	<b>80 150X</b>
Ø 200*	720 × 348	<b>80 200X</b>
With black cover		
Ø 110	642 × 394	<b>80 100S</b>
Ø 125	645 × 387	<b>80 125S</b>
Ø 160	656 × 370	<b>80 150S</b>
Ø 200*	720 × 348	<b>80 200S</b>

\* In-/Outlet Ø 200, hydraulics corresponds to Ø 160