

Pumping station *Aqualift F Basic*

For underground installation

CE EN 12050-1

Pump volume:

25 liters (Mono) / 60 liters (Tronic / Duo)

Polyethylene storage chamber for underground installation (installation depth max. 440 mm), drilling surfaces on three sides for inlet Ø 110/160 mm, pipe gasket and ventilation. With polymer cover, screwed, load class 300 kg.

Float switch controlled **single or twin removable wastewater pump(s)** with multi-vane impeller for wastewater with or without sewage (open channel passage 40 mm). Pump is rated submersible (IP 68). Pressure pipe connection Ø 50/63 mm with integrated non-return flap.

Control unit

Tronic versions with Basic control unit with self-diagnosis system (SDS), battery buffering, control unit is splash proof (IP 54).

Note:

- A ventilation pipe must be provided for on site.
- Consider frost free depth of pressure pipe.
- For installations without explosion proof requirements.

➤ **Accessories:** page 158 – 161

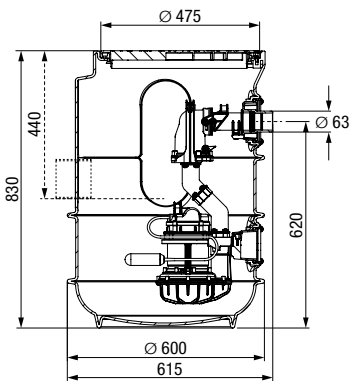

Illustration shows Mono version Art. no. 829 710



Illustration shows Mono version Art. no. 829 710



Illustration shows Duo version Art. no. 828 711



Mono version with one pump

STF pump	Level measurement	Art. no.
Without control unit		
1300-S3	float switch	829 710
With control unit		
1300-S3	float switch	829 711

Duo version with two pumps

STF pump	Level measurement	Art. no.
With control unit		
1300-S3	float switch	828 711

Pump type	Voltage	Amperage	Power (P1/P2)	RPM	Pumping capacity	Pumping height
STF 1300-S3-50%*	230 V ~ 50 Hz	6.0 A	1.3 kW / 0.8 kW	2.650 min ⁻¹	21 m ³ /h	max. 10 m

*Definition of S3-pumps see page 97

Pumping capacity

