

Parking deck drain *Ecoguss*

with pressure sealing flange in stainless steel AISI 304

System 125



Made in *Ecoguss*. Vertical outlet, for connection to SML-pipe according to EN 877, with sludge trap.

Drainage capacity 4.5 l/sec flow rate.

Installation area 300 × 300 mm

With pressure sealing flange in stainless steel AISI 304, with square upper section in *Ecoguss* with connection flange 247 × 247 mm

Cover:

Round slotted cover Ø 234 mm, class B 125 (12.5 to), with *Lack & Lift System*

Note:

Core drilling only Ø 160 mm with *Quick-Fit*

➤ **Accessories:** *Multistop* Art. no. 48 500 see page 283

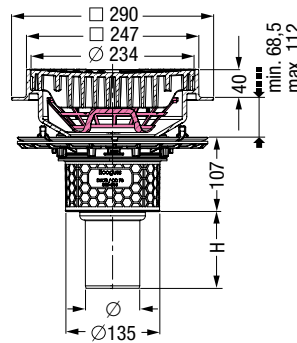

Outer diameter Ø (mm)	Height H in mm	Height H1 in mm	Art. no.
System 125			
Ø 78	110	-	48 878.01
Ø 110	110	-	48 811.01

Parking deck drain *Ecoguss*

square or round

System 100

System 125

Made in *Ecoguss*. Vertical outlet, for connection to SML-pipe according to EN 877, with sludge trap.

Drainage capacity 4.5 l/sec flow rate.

Installation area 300 × 300 mm

With square (247 × 247 mm) or round (Ø 247 mm) upper section in *Ecoguss*

with connection flange

Cover:

Round slotted cover Ø 234 mm, class B 125 (12.5 to), with *Lack & Lift System*

➤ **Accessories:** *Multistop* Art. no. 48 500 see page 283



Illustration shows Art. no. 48 502

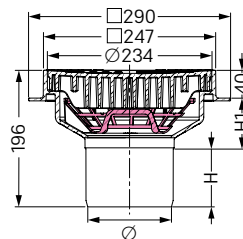

Illustration shows Art. no. 48 501, 48 502

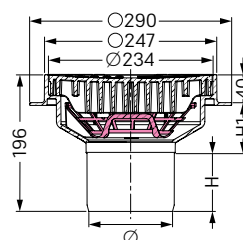

Illustration shows Art. no. 48 503, 48 504

Outer diameter Ø (mm)	Height H in mm	Height H1 in mm	Art. no.
System 100 (SML-pipe) with square upper section			
Ø 110	77	79	48 501
System 125 (plastic pipe) with square upper section			
Ø 125	83	73	48 502
System 100 (SML-pipe) with round upper section			
Ø 110	77	79	48 503
System 125 (plastic pipe) with round upper section			
Ø 125	83	73	48 504