

# Backwater valve *Staufix FKA*

Installation in the floor slab, beginning model year 01/2011

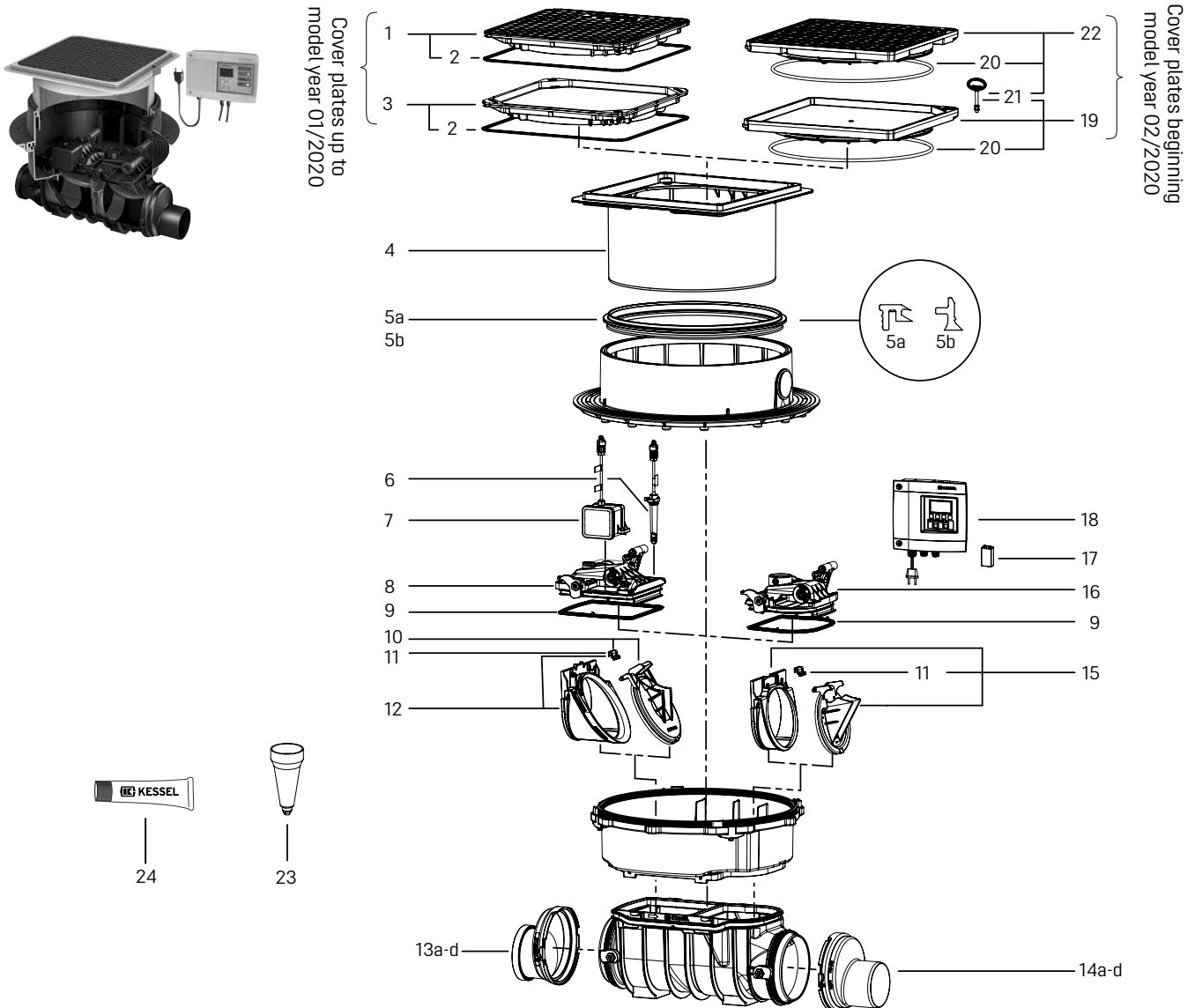

Item	Designation	Art. no.	Item	Designation	Art. no.
1	Cover plate, tileable, surface water resistant, 384 × 384 mm, with seal, up to model year 01/2020	83 052	13c	Ø 160	83 087
2	Seal for cover plate 384 × 384 mm	680 025	13d	Ø 200	83 088
3	Cover plate, black, surface water resistant, 384 × 384 mm, with seal, up to model year 01/2020	83 050	14	Spigot incl. seal	
4	Upper section, Ø 330 mm, height-adjustable up to 170 mm, beginning model year 02/2020	830 061	14a	Ø 110	83 081
5a	Seal for upper section up to model year 06/2014	680 026	14b	Ø 125	83 082
5b	Seal for upper section beginning model year 07/2014	680 150	14c	Ø 160	83 083
6	Spare parts set, optical probe, 5 m cable, with 3 adapters	80 888	14d	Ø 200	83 084
7	Motor, ready to plug in, 5 m cable	80 076	15	Slide-in flap housing with mechanical flap and flap holder	80 041
8	<i>Staufix FKA</i> lockable cover, inlet side	80 016	16	Lockable cover, <i>Staufix FKA</i> , outlet side	80 017
9	Seal set for two-piece lockable cover	70 318	17	Battery, 9 V block	680 034
10	Motor-driven backwater flap, with flap holder	80 038	18	Control unit Comfort 230 V, <i>Staufix FKA</i>	80 071
11	Flap holder	680 101	19	Cover plate, tileable, surface water resistant, with seal, beginning model year 02/2020	830 052
12	Slide-in flap housing for motor-driven flap with flap holder	80 039	20	Seal for cover plate, System 330 mm	686 114
13	Socket incl. seal		21	Release key for <i>Lock &amp; Lift</i> cover plates	67 007
13a	Ø 110	83 085	22	Cover plate, black, surface water resistant, with seal, beginning model year 02/2020	830 050
13b	Ø 125	83 086	23	Test funnel with seal	70 214
			24	High-performance grease for backwater valves, 12 g	681 001