

## Aqualift S Compact lift stat. Tronic, GTF 500, resistant, Floor slab

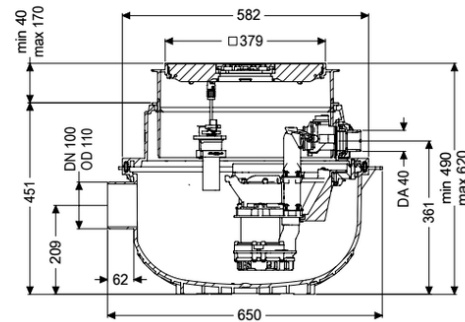

### Article information

Item no.: 280550SC  
GTIN: 4026092082669  
Price group: 20

### Advantages

- Space-saving due to installation in floor slab with integrated drainage function
- Easy retrofitting from Mono to Duo possible
- Quiet operation, as the pump installation does not cause any structure-borne sound emissions.

### Description

The ready to plug in lifting station for faecal-free wastewater is equipped with one or two submersible pumps and a backflow preventer. The collection tank made of permanently resistant polymer (PE) has an open pump tank. One-handed closures enable easy removal of the integrated components. The system for installation in the floor slab is preassembled for final installation on site.

Variant

Type of system:

Resistant:

Single unit

Resistant to saline media, wastewater from water softening systems and wastewater containing condensate from heating systems

Control unit

integrated

Rim width:

Backwater protection:

General characteristics

Colour:

black

Standard:

EN 12050-2

Type of wastewater:

without sewage

Installation situation:

floor slab installation

Delivery state:

Installation-ready (connection parts must be connected on site)

System type:

Tronic

#### Dimensions

|                                                        |                                     |
|--------------------------------------------------------|-------------------------------------|
| Net weight:                                            | 17,31 kg                            |
| Gross weight:                                          | 18,81 kg                            |
| Groundwater resistant from lower edge of base section: | 3000 mm                             |
| Installation depth:                                    | 490 - 620 mm                        |
| Vertical adjustment:                                   | vertically adjustable upper section |
| Width:                                                 | 585 mm                              |
| Length:                                                | 617 mm                              |
| Packaging dimension:                                   | width                               |
| Packaging dimension:                                   | height                              |
| Packaging dimension:                                   | length                              |

#### Tank/drain body

|                                |       |
|--------------------------------|-------|
| Pressure pipe connection (DN): | 32    |
| Pressure pipe connection (OD): | 40 mm |
| Inlet nominal size (DN):       | 100   |
| Pumping volume:                | 20 l  |

#### Coverage features

|                  |                                |
|------------------|--------------------------------|
| Type of cover:   | Cover plate with slotted cover |
| Cover material:  | Polymer                        |
| Colour of cover: | black                          |
| Width of cover:  | 366 mm                         |
| Length of cover: | 366 mm                         |
| Cover locking:   | Lock & Lift                    |
| Load class:      | K 3 (EN 1253-1)                |

#### Pumping device

|                                                    |                                |
|----------------------------------------------------|--------------------------------|
| Pump control:                                      | GTF 500 resistant              |
| Number of pumps:                                   | 1                              |
| Connection type:                                   | coded plug                     |
| Rated current:                                     | 2,7 A                          |
| Length of mains cable for pump:                    | 5 m                            |
| Protection class control unit:                     | IP 68 (3m)                     |
| DSC:                                               | integrated                     |
| Max. temperature (permanent) of conveyed material: | 40 °C                          |
| Hot water resistance for a short time (2 min):     | 80 °C                          |
| Max. pumping capacity:                             | 10 m <sup>3</sup> /h           |
| Max. pumping height:                               | 8 m                            |
| Speed:                                             | 2800 U/min                     |
| Power P1:                                          | 0,6 kW                         |
| Power P2:                                          | 0,36 kW                        |
| Operating mode:                                    | S1                             |
| Type of fuse required (electrical protection):     | C 16 A                         |
| Type of pump connection cable:                     | H07RN-F 3G 1.5 mm <sup>2</sup> |
| Impeller type:                                     | Multi-vane impeller            |
| Free passage:                                      | 10 mm                          |

|                                         |                |
|-----------------------------------------|----------------|
| Control                                 |                |
| Alarm sensor:                           | optical probe  |
| Level measurement instrument:           | Immersion pipe |
| Type of level measurement:              | pneumatic      |
| Protection class probe:                 | IP 54          |
| Mains frequency:                        | 50 Hz          |
| Operating voltage:                      | 230 V          |
| Connection type:                        | coded plug     |
| Length of mains cable for control unit: | 1,4 m          |
| Potential-free contact:                 | optional       |
| GSM interface:                          | yes            |
| USB interface:                          | yes            |
| Log book function:                      | yes            |
| Multi-line display:                     | yes            |
| Battery buffering:                      | yes            |
| Self-diagnosis system (SDS):            | yes            |
| Max. permissible switching frequency:   | Comfort        |