

Lifting station Minilift L KTP 300, resistant, Floor slab, black

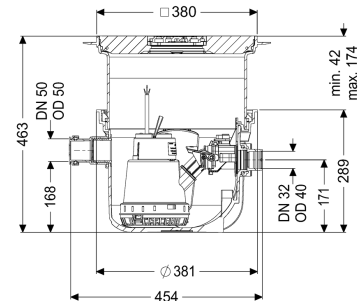

Article information

Item no.: 280570SC
GTIN: 4026092093511
Price group: 20

Advantages

- Space-saving installation in the floor slab with integrated drainage function
- System ready to plug in
- Easy tool-free maintenance

Description

The ready to plug in small lifting station for faecal-free wastewater is suitable for wastewater drainage of individual sanitary appliances. The submersible pump with float switch can be removed easily with the help of one-handed closures. The collection tank made of polymer (PE) has an open pump tank and is resistant to aggressive wastewater. The system for installation in the floor slab is preassembled for final installation on site.

Variant

Type of system:
Resistant:

Single unit
Resistant to waste water containing salt, softener and condensate
Float switch
integrated

Pump control:
Backflow preventer:

General characteristics

Colour:
Standard:
Type of wastewater:
Installation situation:
Delivery state:

grey
EN 12050-2
without sewage
floor slab installation
Installation-ready (connection parts must be connected on site)

Dimensions

Net weight: 10,8 kg

| | |
|-------------------------------|-------------------------------------|
| Gross weight: | 11,8 kg |
| Installation depth: | 330 - 460 mm |
| Type of height adjustability: | vertically adjustable upper section |
| Length: | 460 mm |
| Width: | 380 mm |
| Packaging dimension: | length |
| Packaging dimension: | width |
| Packaging dimension: | height |

| | |
|--------------------------------|-------|
| Tank/drain body | |
| Pressure pipe connection (DN): | 32 |
| Pressure pipe connection (OD): | 40 mm |
| Inlet nominal size (DN): | 50 mm |
| Pumping volume: | 7 l |
| Tank volume: | 26 l |

| | |
|-------------------|--------------------------------|
| Coverage features | |
| Type of cover: | Cover plate with slotted cover |
| Cover material: | Polymer |
| Colour of cover: | black |
| Width of cover: | 366 mm |
| Length of cover: | 366 mm |
| Locking: | Lock & Lift |
| Load class: | K 3 (EN 1253-1) |

| | |
|--|--------------------------------|
| Pumping device | |
| Pump: | KTP 300 resistant |
| Number of pumps: | 1 |
| Weight, pump: | 4 kg |
| Connection type: | Schuko (earthed contact) 2-pin |
| Protection class: | I |
| Insulation class: | F |
| Protection class (pump): | IP 68 (3m) |
| Temperature monitoring: | integrated |
| Max. temperature (permanent) of conveyed material: | 40 °C |
| Hot water resistance for a short time (2 min): | 80 °C |
| Max. pumping capacity: | 8 m³/h |
| Max. pumping height: | 6 m |
| Speed: | 2800 U/min |
| Power P1: | 0,34 kW |
| Power P2: | 0,21 kW |
| Operating mode: | S1 |
| Type of pump connection cable: | H07RN-F 3G 1.5 mm² |
| Impeller type: | Multi-vane impeller |
| Free passage: | 10 mm |
| Type of fuse required (pump): | C 16 A |
| Length of mains cable for pump: | 5 m |
| Rated current: | 1,6 A |

| | |
|-------------------------------|--------------------------------|
| Control | |
| Motor protection switch: | yes |
| Level measurement instrument: | Float switch |
| Type of level measurement: | mechanical |
| Mains frequency: | 50 Hz |
| Operating voltage: | 230 V |
| Connection type: | Schuko (earthed contact) 2-pin |