

## Shell Kit for Minilift S, underground, tileable

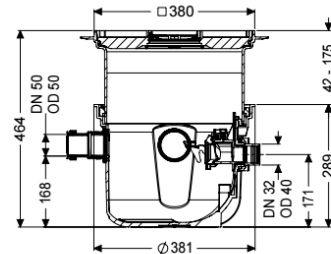

### Article information

Item no.: 280570X-RBK

GTIN: 4026092106822

Price group: 20

### Description

For combination with a KESSEL technology kit for creating a Minilift S small lifting station for wastewater without sewage.

The ready to plug in small lifting station for wastewater without sewage is suitable for the disposal of wastewater from individual drainage sources. The submersible pump with float switch can be removed easily with the help of one-handed closures. The collection tank made of polymer (PE) has an open pump tank and is resistant to aggressive wastewater. The system for installation in the floor slab is pre-assembled for final installation on site.

### KESSEL shell kit consisting of:

- With vertically adjustable upper section for continuous height and level compensation and integrated floor drain
- Includes backflow preventer for the pressure pipe
- Includes DN 50 connection socket for inlet and conduit pipe

### General characteristics

Colour:	grey
Standard:	EN 12050-2
Type of wastewater:	without sewage
Installation situation:	floor slab installation
ATEX:	no

### Dimensions

Net weight:	7,17 kg
Gross weight:	7,17 kg
Installation depth:	330 - 460 mm
Length:	460 mm
Width:	380 mm
Packaging dimension:	length
Packaging dimension:	width
Packaging dimension:	height

Tank/drain body	
Pressure pipe connection (DN):	32
Pressure pipe connection (OD):	40 mm
Inlet nominal size (OD):	60 mm
Inlet nominal size (DN):	50 mm
Pumping volume:	7 l

#### Coverage features

Type of cover:	tileable cover plate
Cover material:	Polymer
Colour of cover:	grey
Width of cover:	366 mm
Length of cover:	366 mm
Locking:	Lock & Lift
Load class:	K 3 (EN 1253-1)