

## Sampling chamber LW 400, DN 100/150, class B, ventilated

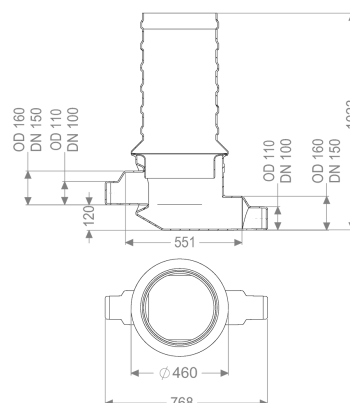

### Article information

Item no.: 916880B

GTIN:

Price group: 60

### Description

Sampling chamber LW 400, DN 100/150, class B, ventilated

for separator systems, for underground installation, made of polyethylene, draining, watertight, resistant to aggressive waste water.

Upper section made of polymer for continuous adjustable height and level adjustment.

Cover plate made of grey cast iron to EN 124, including ventilation.

Nominal size:	DN 100/150 (OD 110/160 mm)
Installation depth inlet:	900 to 1300 mm (can be shortened by sawing to 400 mm)

Variant	
Direction of flow:	straight
Chamber system:	LW 400

Dimensions	
Net weight:	25 kg
Gross weight:	30 kg
Vertical drop between inlet and outlet:	120 mm
Installation depth:	400 - 1300 mm
Packaging dimension:	length
Packaging dimension:	width
Packaging dimension:	height

Coverage features

Type of cover:

Load class:

surface water resistant

B 125 (EN 124)